

Haywood

191222B

Width 56 Depth 52

SQUARE FOOTAGE

HEATED

FIRST FLOOR 1681 SQ.FT.
TOTAL 1681 SQ.FT.

UNHEATED

GARAGE 549 SQ.FT.
FRONT PORCH 135 SQ.FT.
TOTAL 684 SQ.FT.



FRONT ELEVATION

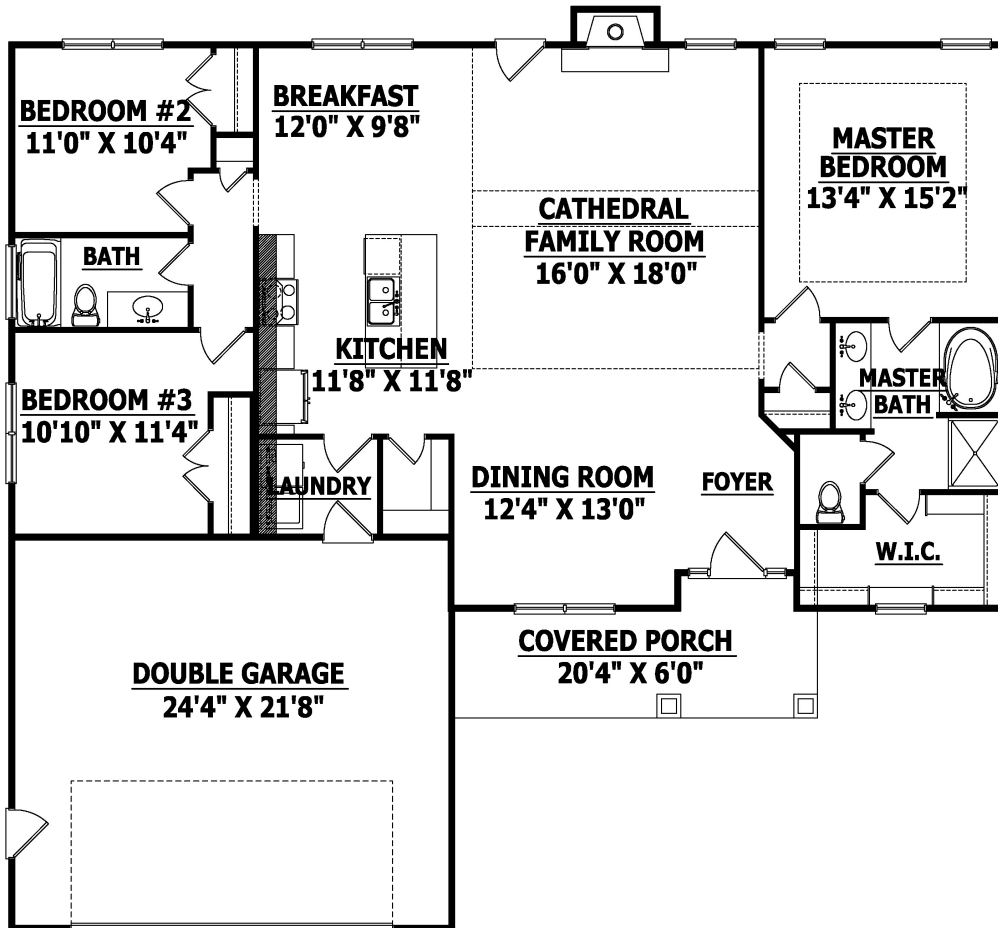

FIRST FLOOR